

CLEARSONICS CONTROLLERCOM

CONTROLLERCOM FLUSH MOUNT

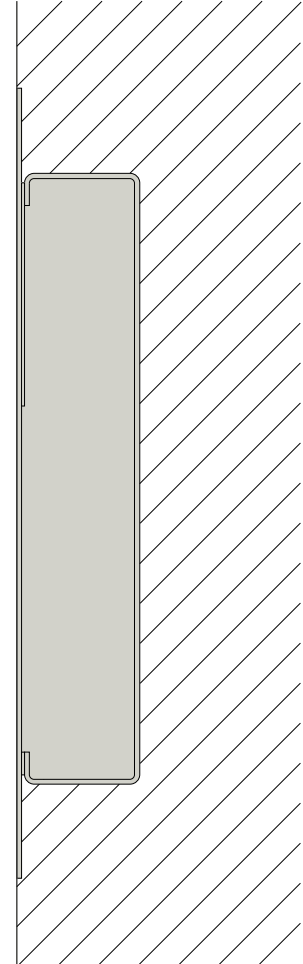
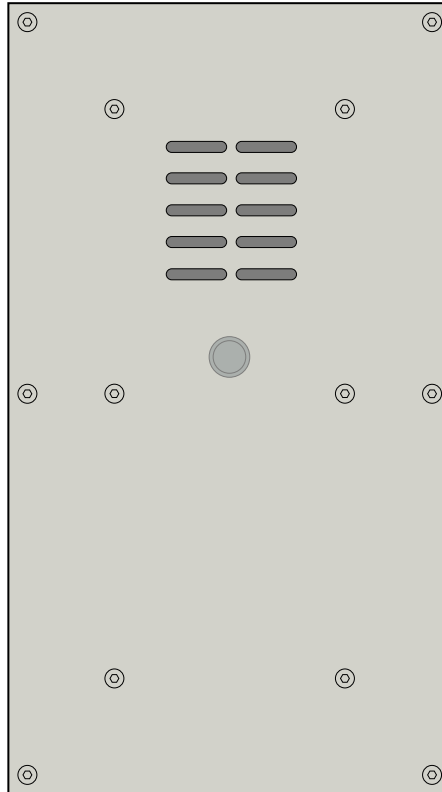

The Clearsonics IP Controllercom (controller/intercom) allows hands free Voice communications over wired IP networks (VoIP). With appropriate software, the Controllercom may also be used as an IP based public address system. Line level monitoring/recording outputs are available for both local and remote audio signals. The local voice signal (mic input) can also be transmitted to a "Recording Server" located on a separate IP address. Voice calls can be autonomously terminated after programmable 'no data' or 'in call' periods have been exceeded.

One or two 'call' buttons can be provided allowing calls to be established with up to two remote locations; a switchboard and gatehouse for example. The SIP number dialed when a button is pressed (and other

operational parameters) may be re-programmed from any computer connected to the same IP network.

Logic level inputs and outputs are provided to allow remote control and monitoring of equipment at the Controllercom location. Input state changes can be manually read by command or presented as unsolicited reports over the IP link. Output states can be controlled by command over the IP link. Adapter modules can be provided to allow interfacing with equipment having incompatible electrical requirements. Examples for the use of these facilities include remote monitoring of gate/door latch state, remote access control by operation of a lock solenoid or remote activation of security cameras or control of camera direction and zoom.

Two open collector LED drive outputs are available to provide device state information (LINK DOWN, IDLE, IN CALL, ON HOLD/QUEUED). These may drive an optional bi-colour indicator on the Controllercom housing or be used to control external LED indicators.

Simple asynchronous serial communications can be provided for serial control or interrogation of connected equipment.

A 4 Watt, 12V to 24V DC power supply is required for operation. If additional devices are to be powered from this supply, it should be scaled appropriately. Clearsonics can provide a high quality 25W/15V switching supply that will operate reliably to +70 degrees.

CONTROLLERCOM SURFACE MOUNT

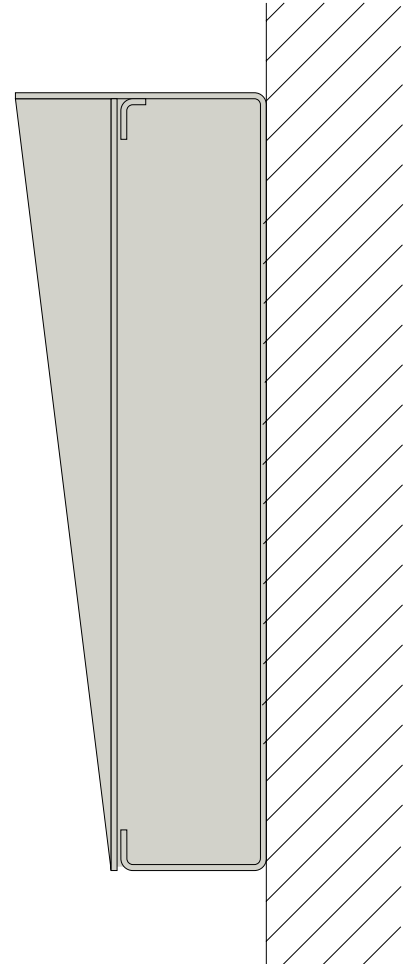
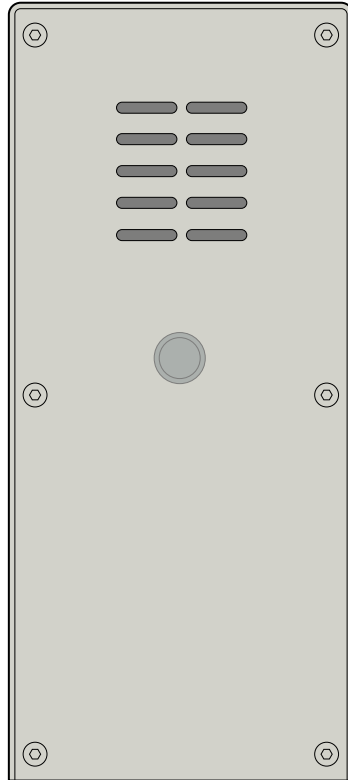
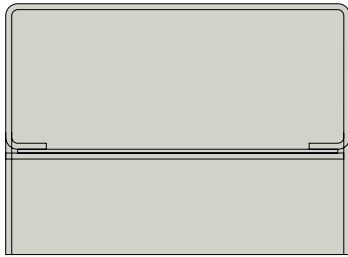

TECHNICAL SPECIFICATIONS: CLEARSONICS CONTROLLERCOM

Model: VoIP-SA 1162

Operating temperature: 0°C to 70°C

Storage temperature: -40°C to 70°C

Humidity: 5 to 95% non-condensing

Power Requirements: 12V - 24V DC 1A

Power Consumption

Idle current 65mA

Typical current while call in progress 80mA

Maximum current while call in progress
150mA

Dimensions

Surface 326 x 144 x 105mm

Flush 418 x 234 x 65mm

Supported protocols

G.711 mu-law + A-Law

Session Initiation Protocol (SIP) RFC 3261

Real-Time Transport Protocol (RTP) RFC 3550

Session Description Protocol (SDP) RFC 2327

Trivial File Transfer protocol (TFTP) RFC 1350

User Datagram Protocol (UDP) RFC 0768

Physical connections

Local area network (LAN) connector

Audio specifications

G711 (mu-law + A-Law)

Audio in 1.0V

Audio out 1.0V